

ROOM OVERVIEW

Spaces	⌘	⌘	⌘	⌘	⌘	∩	m2	Length	Width	Height	Terrace
1st floor											
Conference room 1 + 2	-	60	230	310	90	230	301	21.5	14	5	-
Conference room 1	-	42	135	170	-	150	203	14.5	14	5	-
Conference room 2	-	36	48	90	-	80	98	14	7	5	-
Foyer A	-	-	-	-	-	60	160	-	-	2.8	-
Ground floor											
Restaurant	-	-	-	-	180	250	270	21.5	12	3	✓
Restaurant + meeting room 1	-	-	-	-	220	310	330	29.5	19.5	3	✓
Meeting room 1	-	12	-	-	40	50	60	8	7.5	3	✓
Foyer B	-	-	-	-	-	150	170	-	-	2.6	-
Park terrace	-	-	-	-	-	150	160	-	-	2.8	✓
1st basement											
Meeting room 2	14	16	18	40	30	40	49	7.5	6.5	2.9	-
Meeting room 3	-	26	34	60	50	60	95	12.5	7.5	2.8	✓
Library	-	42	50	80	70	80	135	18	7.5	2.8	-
Lake terrace	-	-	-	-	-	60	40	-	-	-	✓
Foyer C	-	-	-	-	-	20	70	-	-	2.7	-
2nd basement											
Meeting room 4	10	-	-	22	-	-	25	5.6	4.5	2.5	✓
Meeting room 5	12	-	-	28	-	-	37	7.5	4.9	2.6	✓
Meeting room 7	14	16	18	32	-	-	56	7.6	7.4	2.6	-
Meeting room 8	14	16	18	32	-	-	55	7.6	7.4	2.6	-
Meeting room 7 + 8	-	34	42	70	-	-	112	15.2	7.4	2.6	-

Widescreen

In conference room 1, you can take advantage of a high-tech widescreen, which is a production and presentation system for large screens with unprecedented image quality and resolutions. Using widescreen technology, images, presentations, videos and camera signals can be freely positioned on the projection screen or superimposed and hence flexibility integrated into your event.

FLOORPLANS

1st Floor



Ground Floor

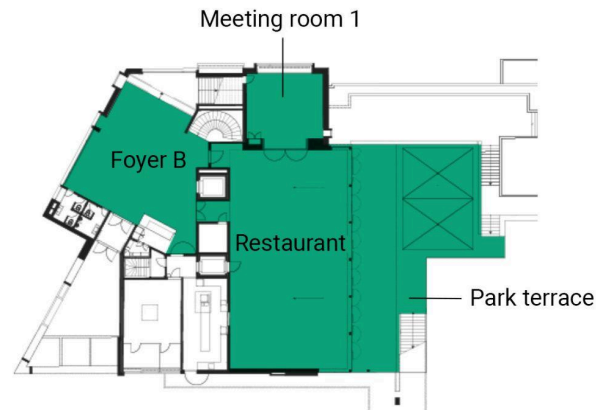

1st Basement

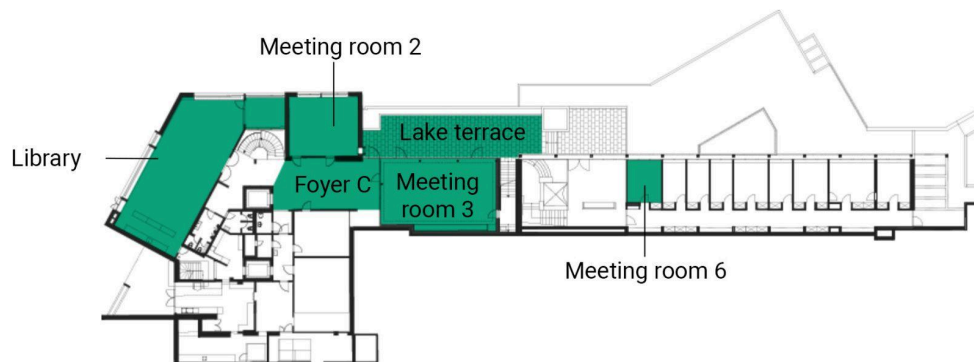

2nd Basement

